

SHOP / STORAGE SPACE FOR LEASE

1.5+- MILES NORTH OF WADE HAMPTON BLVD (HWY 29)

1729 LOCUST HILL ROAD (HWY 290), GREER

- 12'X14' DRIVE-IN DOOR
- PERSONAL DOOR
- RESTROOM
- 16' CEILING

800+- SF

DEVELOPMENT HAS
CODED ENTRY GATE

AVAILABLE APRIL 1ST: UNIT C3



WIRELESS INTERNET: \$40/MO
TRAILER PARKING AVAILABLE:
30' LONG SPOTS: \$65/MO
40' LONG SPOTS: \$95/MO

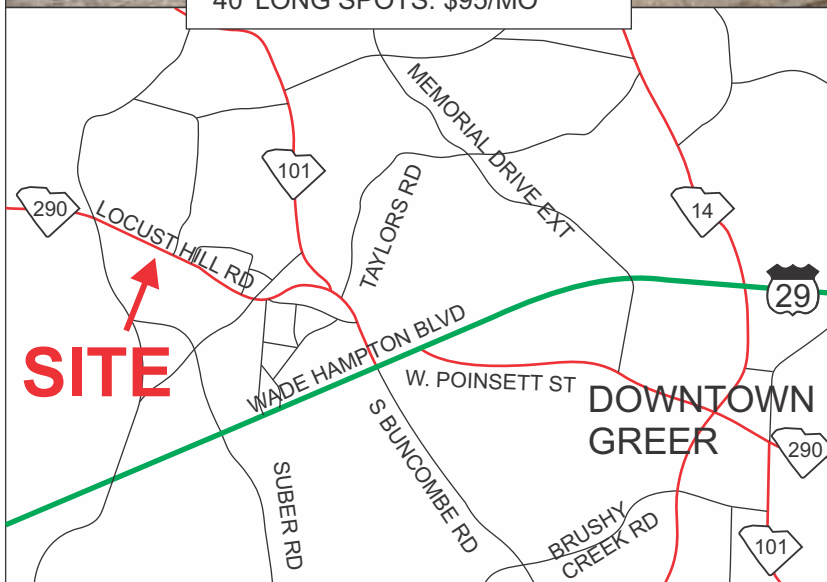

- NOT HEATED OR COOLED
- OCCUPANCY PERMIT REQUIRED BY GREENVILLE COUNTY
- UNZONED IN GREENVILLE COUNTY
- TAX MAP T009.03-01-018.01
- PUBLIC WATER / SEPTIC
- ONE YEAR LEASE TERM

LEASE RATE: \$775/MONTH

TENANT PAYS FOR POWER

FOR MORE INFORMATION CONTACT
CHUCK LANGSTON AT 864-230-4302
clangston@langston-black.com

Langston Black
REAL ESTATE, INC.

P.O. BOX 2167
GREER, S.C. 29652
BUS: 864-848-9070

423

www.langston-black.com

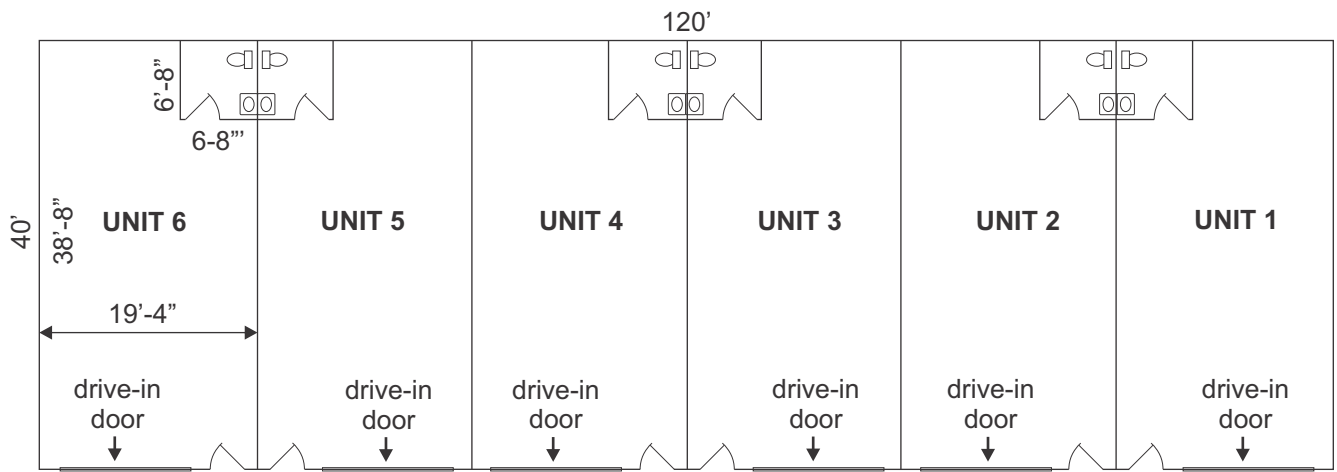

All bays have 16' high ceilings

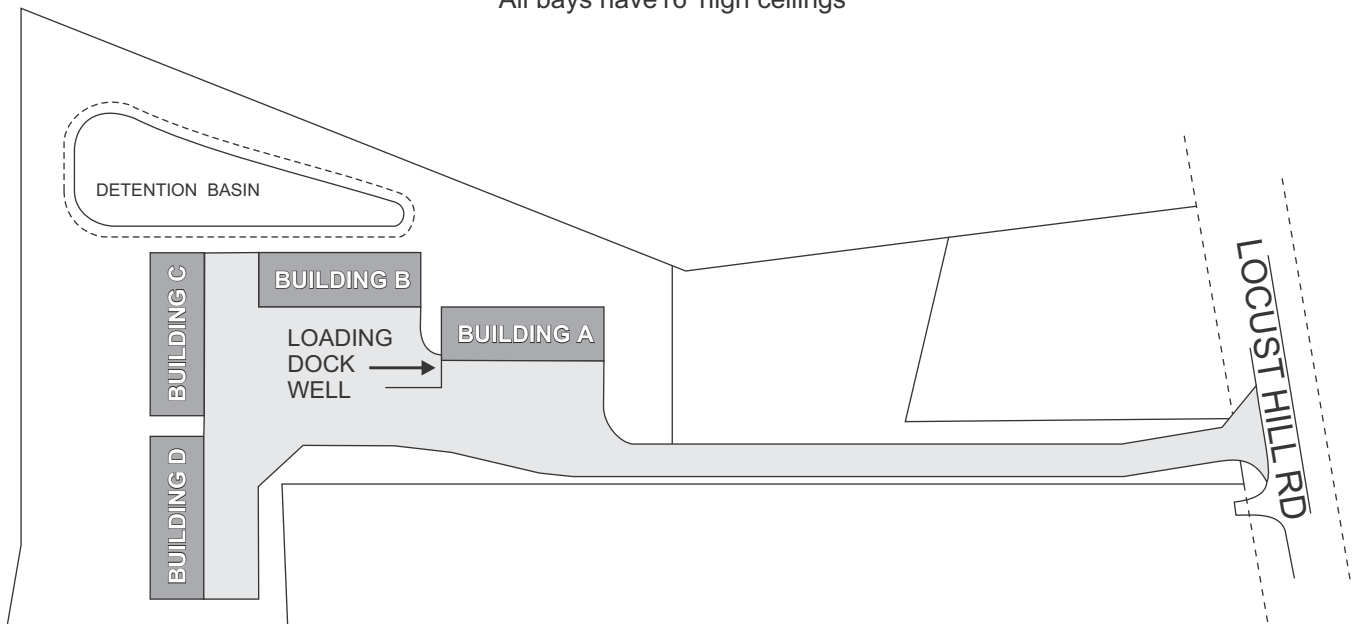



BUILD OUT OF AVAILABLE
SPACE MAY DIFFER SLIGHTLY
FROM PICTURES SHOWN

