

LANGSTON BLACK

REAL ESTATE, INC.

RETAIL SPACE FOR LEASE

SHOPPES AT NORTH MAIN

339 NORTH MAIN STREET, WOODRUFF, SC 29388

8,000+- SF SPACE



FOR
LEASE

351

347

341

339

ZONED C3 BY THE CITY OF WOODRUFF
SPARTANBURG COUNTY TAX MAP 4-32-03-110.00

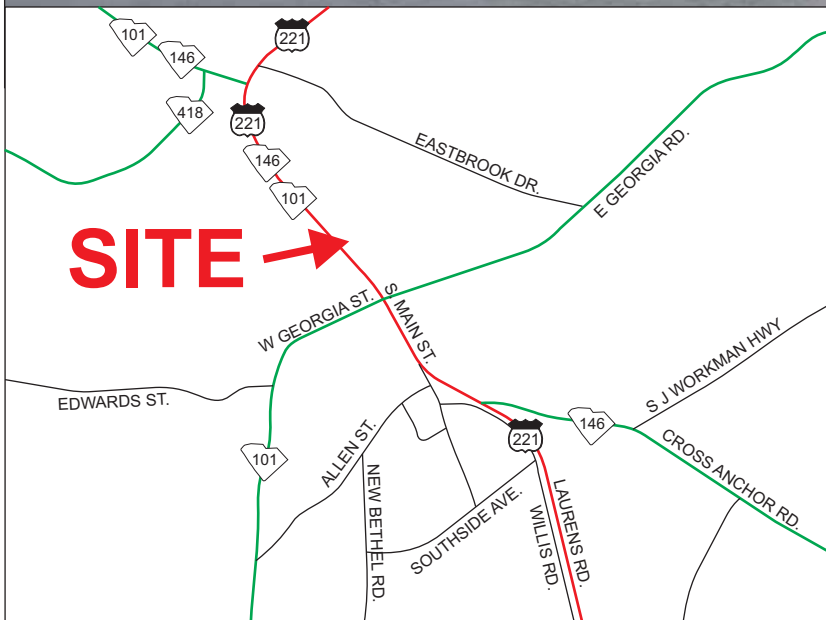

OTHER CENTER TENANTS:
DOLLAR GENERAL
WOODRUFF TOBACCO & VAPE

LEASE RATE: \$6.50/SF NNN

FOR MORE INFORMATION CONTACT
BRADLEY TOY, CCIM, AT 864-640-7429
btoy@langston-black.com

LANGSTON BLACK
REAL ESTATE, INC.

P.O. BOX 2167
GREER, S.C. 29652
BUS: 864-848-9070

408

www.langston-black.com

Every effort has been made to ensure the accuracy of the enclosed data, but we assume no responsibility for errors. All conditions and pricing subject to change without notice.
(LANGSTON-BLACK SITE #408)

339 N. MAIN STREET
RIGHT END CAP SPACE

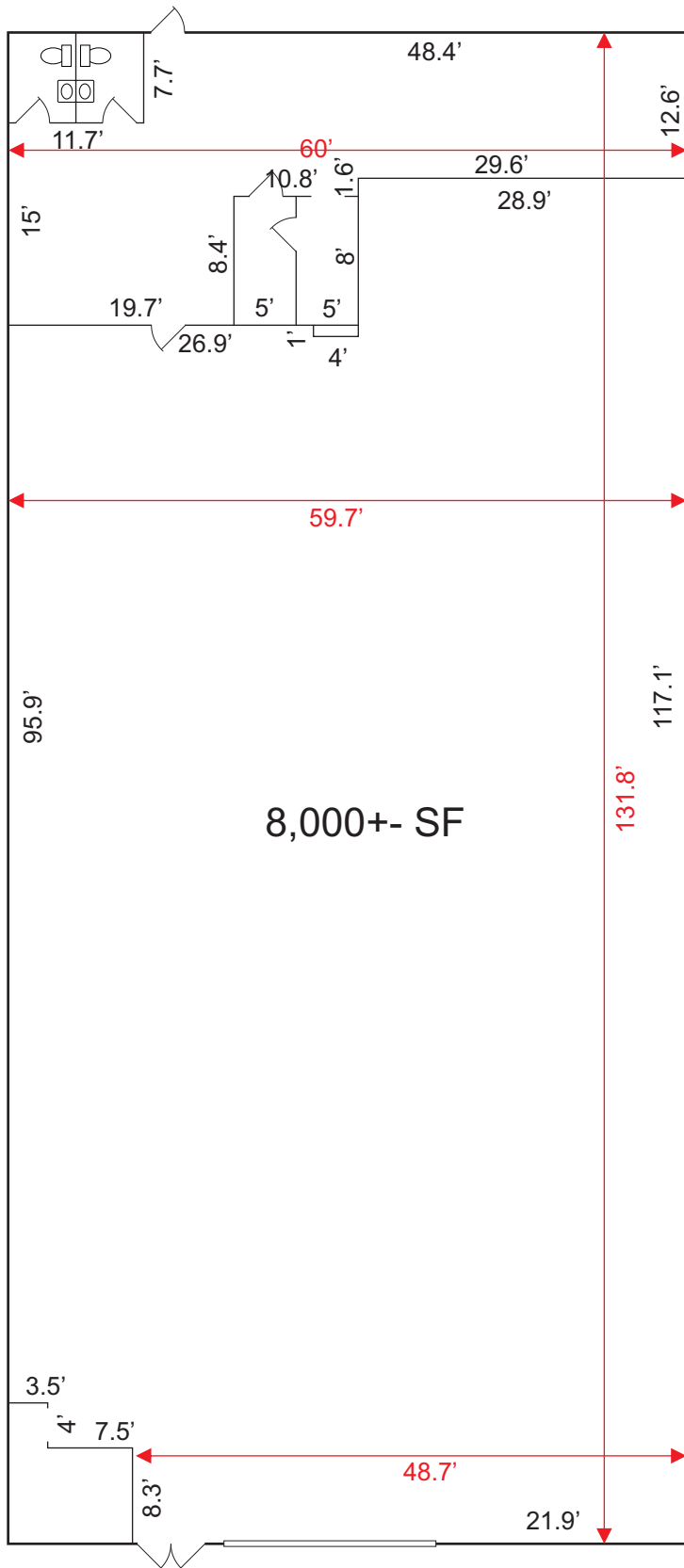

LAYOUT SCALE 1:16



2020 DEMOGRAPHICS	1 MILE	3 MILES	5 MILES
TOTAL POPULATION	6,238	11,748	63,362
TOTAL HOUSEHOLDS	2,383	4,482	23,068
AVG. HH INCOME	\$48,956	\$58,286	\$82,919
TRAFFIC COUNT (NORTH MAIN & CHURCH ST): 13,660 VPD			