

PINE FOREST DRIVE, GREER

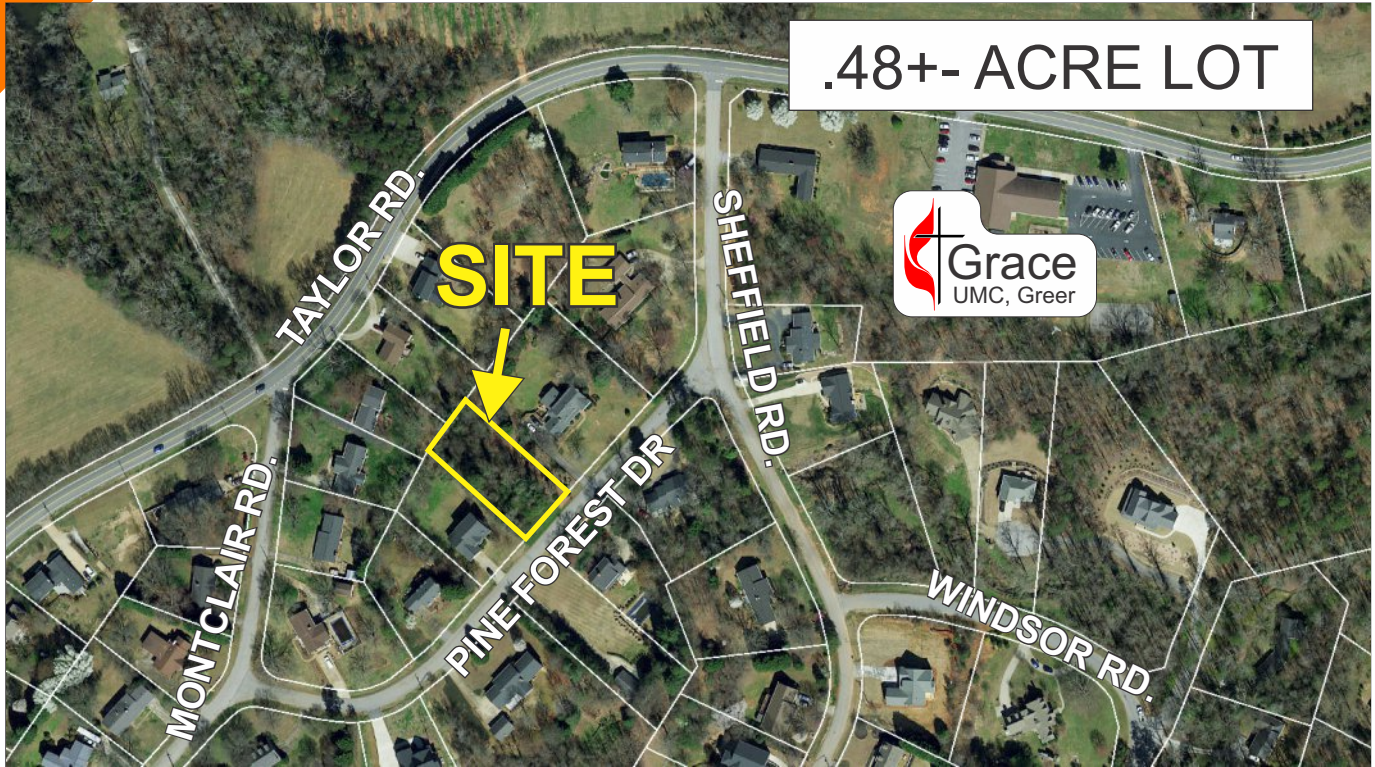

.48+- ACRE LOT

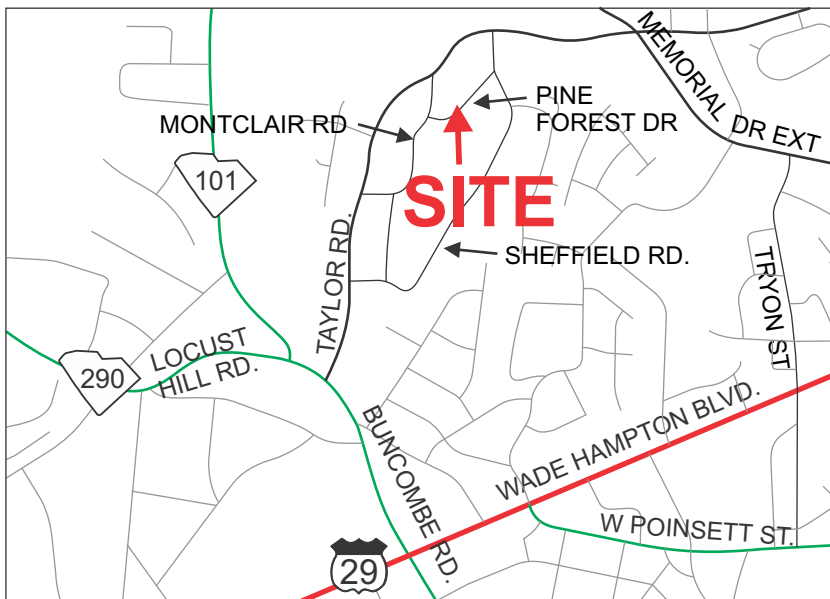

- MINIMUM HOUSE SIZE ALLOWED IS 2,200 SF
- ALL UTILITIES AVAILABLE
- TAX MAP T018.01-04-005.00

\$49,900

FOR MORE INFORMATION CALL
JEFF HOWELL AT 864-419-5999
jhowell@langston-black.com

LANGSTON BLACK

REAL ESTATE, INC.

P.O. BOX 2167
GREER, S.C. 29652
BUS: 864-848-9070

079

www.langston-black.com



SITE



UNZONED IN GREENVILLE COUNTY
 BUT PROPERTY USE REGULATED BY
 SUBDIVISION PROTECTIVE COVENANTS