

LANGSTON BLACK

REAL ESTATE, INC.

OWNER FINANCING AVAILABLE

LAND FOR SALE

JUST OFF OF WOODRUFF RD. (.4 MILE)

400 SCUFFLETOWN ROAD, SIMPSONVILLE

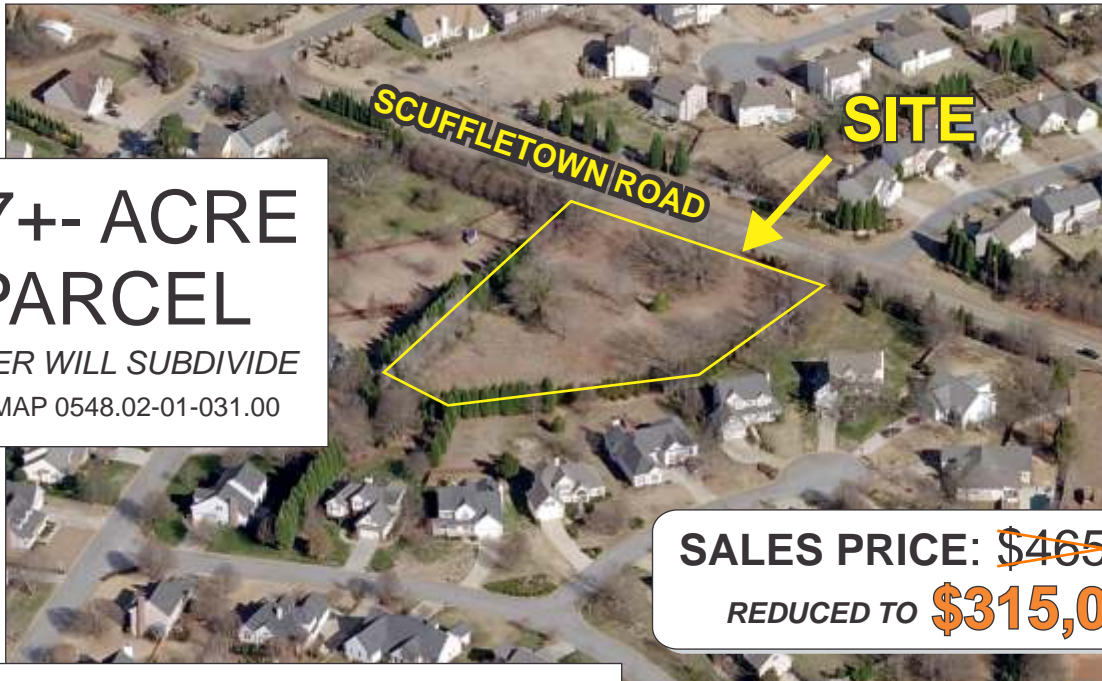

1.7+- ACRE
PARCEL

OWNER WILL SUBDIVIDE
TAX MAP 0548.02-01-031.00

SALES PRICE: ~~\$465,000~~
REDUCED TO **\$315,000**

WITH REZONING WOULD BE GREAT
PROFESSIONAL OFFICE LOCATION

FOR MORE INFORMATION CONTACT RICK
HAMMETT AT 864-313-9507
rhammett@langston-black.com

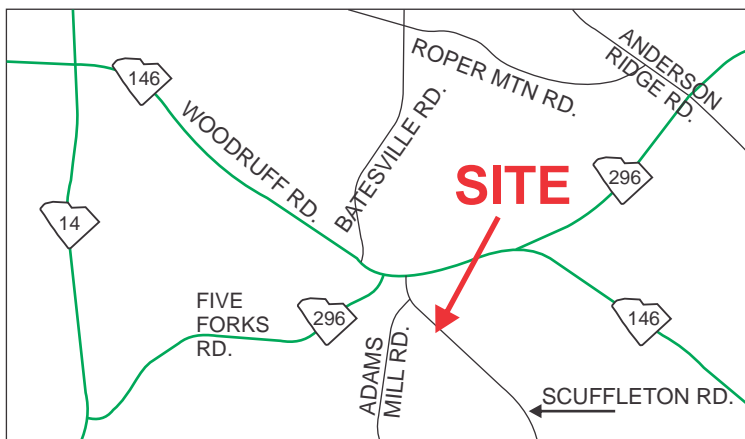

LANGSTON BLACK
REAL ESTATE, INC.

P.O. BOX 2167
GREER, S.C. 29652
BUS: 864-848-9070

110

www.langston-black.com

Every effort has been made to ensure the accuracy of the enclosed data, but we assume no responsibility for errors. All conditions and pricing subject to change without notice.
(LANGSTON-BLACK SITE #110)

