

LANGSTON BLACK

REAL ESTATE, INC.

TWO CORNER PARCELS FOR SALE

CORNER OF MULBERRY ST. AND PETE HOLLIS BLVD., GREENVILLE

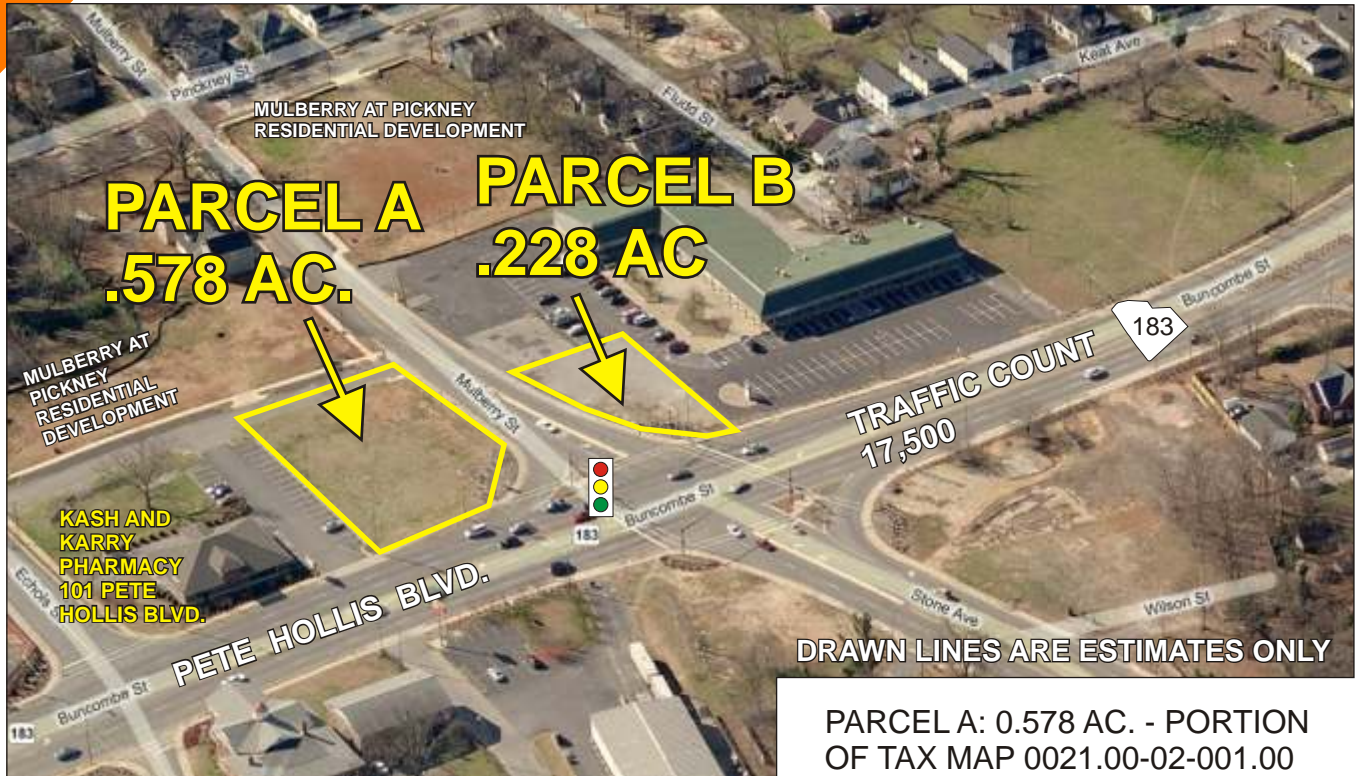

ZONED RDV (REDEVELOPMENT DISTRICT)

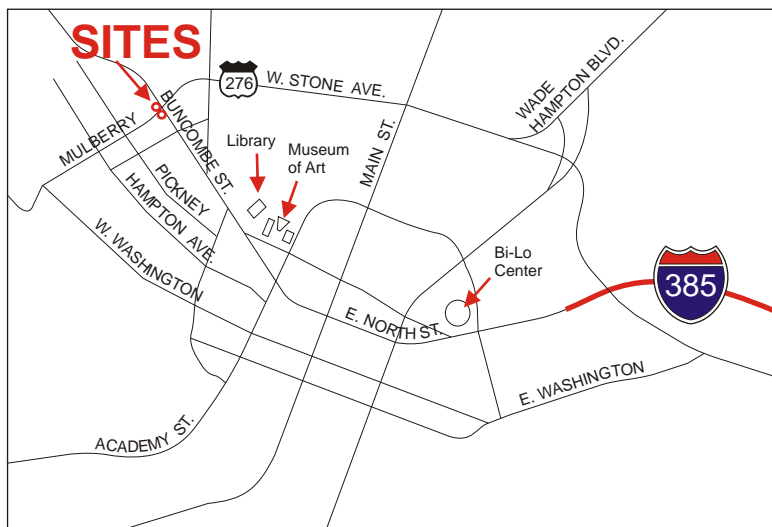

PARCEL A: 0.578 AC. - PORTION
OF TAX MAP 0021.00-02-001.00
INCLUDES OFF SITE STORM WATER DETENTION
\$350,000

PARCEL B: 0.228 AC.
TAX MAP 0028.00-01-001.05
\$110,000 OR \$1,000/MONTH
GROUND LEASE

FOR MORE INFORMATION CALL CHUCK
LANGSTON AT 230-4302 OR BRAD TOY
AT 640-7429

LANGSTON BLACK
REAL ESTATE, INC.

P.O. BOX 2167
GREER, S.C. 29652
BUS: 864-848-9070

87

www.langston-black.com

Every effort has been made to ensure the accuracy of the enclosed data, but we assume no responsibility for errors. All conditions and pricing subject to change without notice.
(LANGSTON-BLACK SITE #87)

