

LANGSTON BLACK

REAL ESTATE, INC.

117,119 & 121 SOUTH SUBER ROAD

FOR SALE

CAN BE COMBINED TO FORM A 1.57+- ACRE SITE

LOCATED JUST OFF OF HWY 29 ON SUBER RD.



SITE 68 - 117 S. SUBER ROAD - .60+- ACRES - **\$178,000** TAX MAP T013.00-03-012.00

SITE 69 - 119 S. SUBER ROAD - .52+- ACRES - **\$170,000** TAX MAP T013.00-03-013.00

SITE 70 - 121 S. SUBER ROAD - .45+- ACRES - **\$175,000** TAX MAP T013.00-03-015.00

CURRENTLY ZONED R-20
(NOT IN GREER CITY LIMITS)

FOR MORE INFORMATION CONTACT
TIM ALLENDER AT 884-2198

LANGSTON BLACK
REAL ESTATE, INC.

P.O. BOX 2167

GREER, S.C. 29652

BUS: 864-848-9070

068-070

www.langston-black.com

Every effort has been made to ensure the accuracy of the enclosed data, but we assume no responsibility for errors. All conditions and pricing subject to change without notice.
(LANGSTON-BLACK SITE #068-070)



HOUSES CURRENTLY LOCATED ON ALL THREE PARCELS

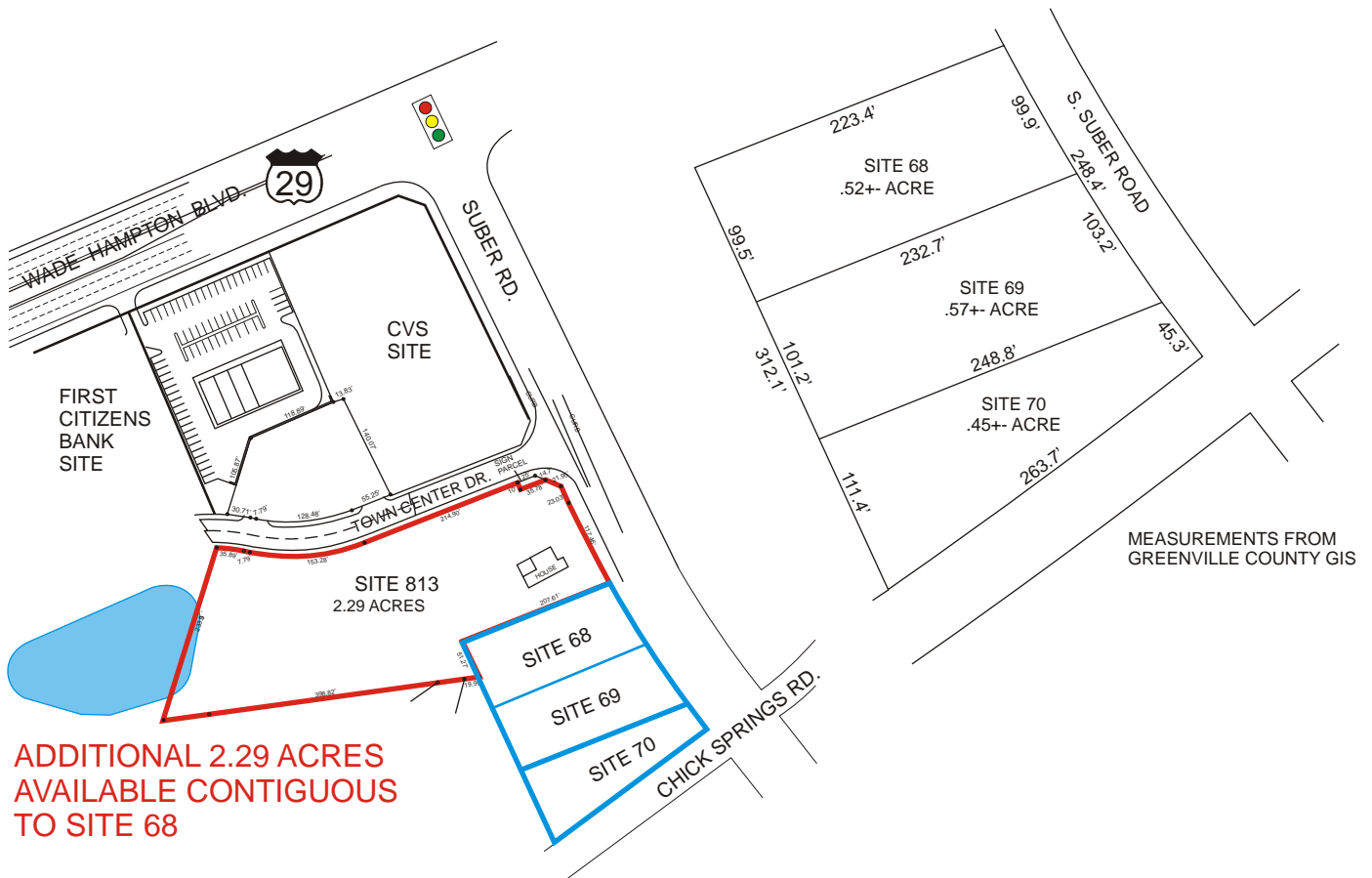

**ADDITIONAL 2.29 ACRES
AVAILABLE CONTIGUOUS
TO SITE 68**